

Quick Installation Guide

5G Wi-Fi6 Wireless CPE

Model: NR1800X

1 Installation Diagram

Method 1: Wireless Connection to the Internet(with SIM card)

1. Insert the SIM card into the slot.
 2. Power on the router.
 3. Find the default Wi-Fi name on your Phone and choose to connect. Now, you could enjoy Wi-Fi.
 4. For security, please follow the below instructions to create passwords for your router and Wi-Fi.
- Note:
Micro or Nano card must be turned into the SIM card by using the standard SIM card adapter.

Default Wi-Fi Name:
NR1800X
NR1800X_5G

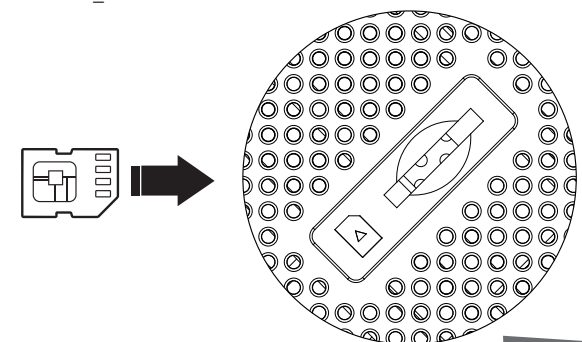

Method 2: Wired Connection to the Internet (with Cable)

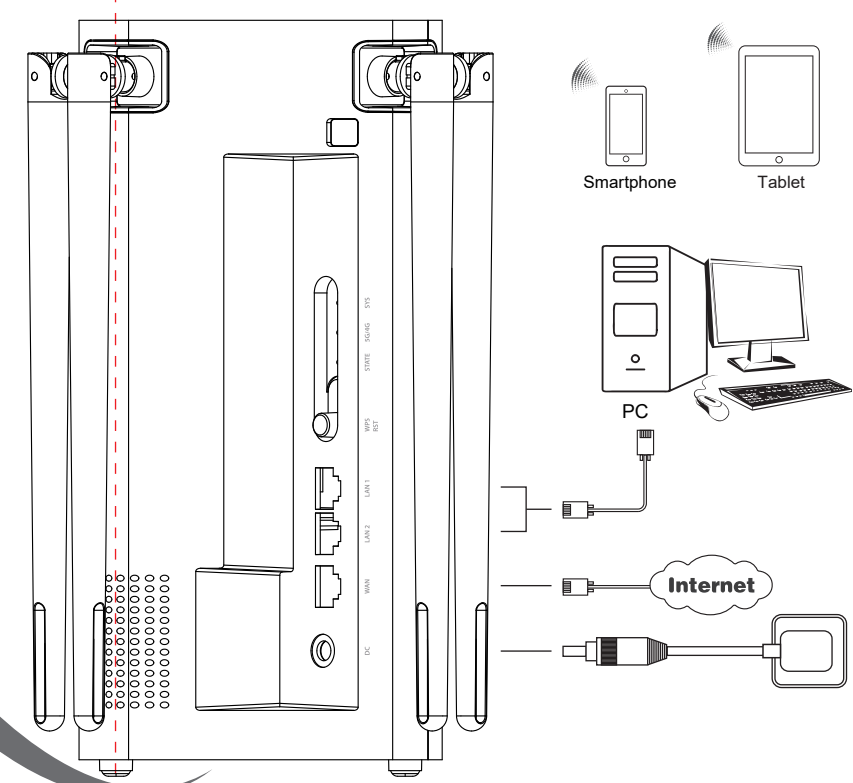

2 Configure the Router on Phone

4 Time Zone setting. According to your location, please click the Time Zone to choose a correct one from the list, then click **Next**. (P4)

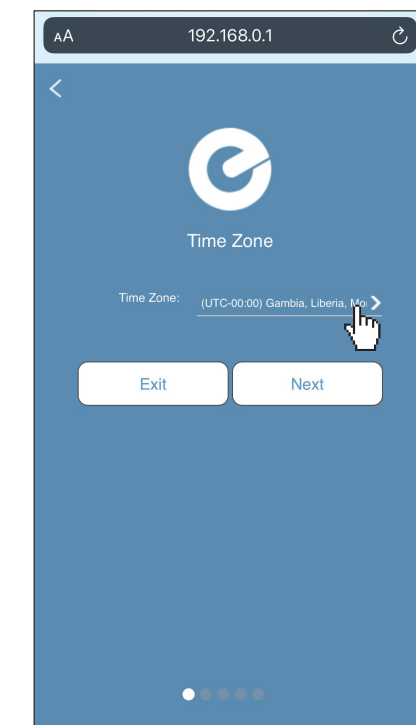

(P4)

5 Internet Setting. Choose a suitable connection type from the list and fill in the information required, then click **Next**.(P5/P6)

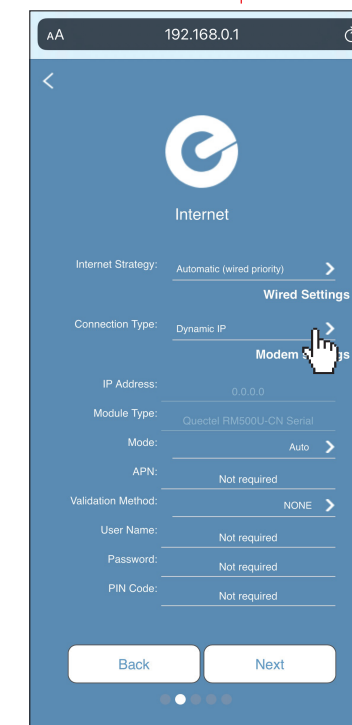

(P5)

6 Wireless Setting. Create passwords for 2.4G and 5G Wi-Fi (Here users could also revise the default Wi-Fi name) and then click **Next**.(P7)

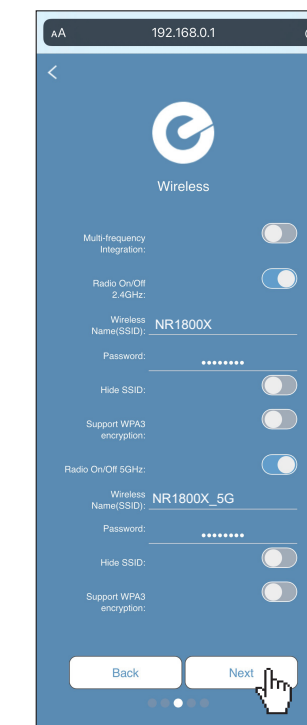

(P7)

7 For security, please create a new Login Password for your router, then click **Next**.(P8)

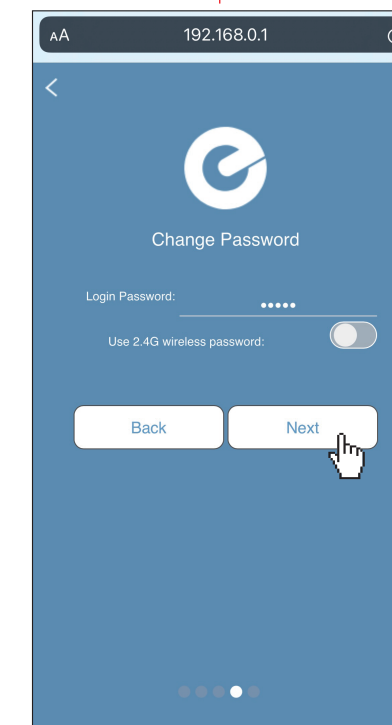

(P8)

8 The coming page is the Summary information for your setting. Please remember your Wi-Fi Name and Password, then click **Done**.(P9)

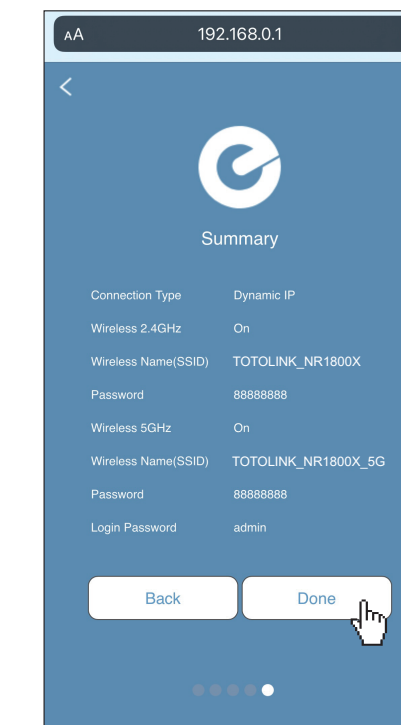

(P9)

Indicators, Ports, Buttons

SYS	Off	The system does not start.
	Blinking (1s:1s=On:Off)	System startup is complete.
5G/4G	The blue light stays on for two minutes.	Press the WPS button, the WPS function is awakened.
	Blinking (100ms:100ms=On:Off)	Press the reset button for 5seconds. Router is being reset, ready to reboot.
STATE	Blue light is always on.	Connect to 5G signal.
	The blue and orange lights are blinking.	Cannot connect to 5G/4G signal.
DC In	Blue light is always on.	The signal is strong.
	Orange light is always on.	The signal is average.
WAN Port	Off	Cannot connect to 5G/4G signal or connect to 3G signal.
	Connect to the power source.	
LAN Ports	Connect to the Internet.	
SIM Slot	Connect to PCs.	
WPS/RST Button	Insert the SIM card.	
	Activate the WPS function: press and hold the button(for 1-3seconds) until the system indicator becomes solid light.	
	Reset the router to factory settings: press and hold the button (for 5-8 seconds) until the system indicator becomes quick blinking light.	

2 Configure the Router on Phone

1 Activate the WLAN function on your Phone and connect to NR1800X or NR1800X_5G. Then run any Web browser and enter <http://192.168.0.1> in the address bar.(P1)

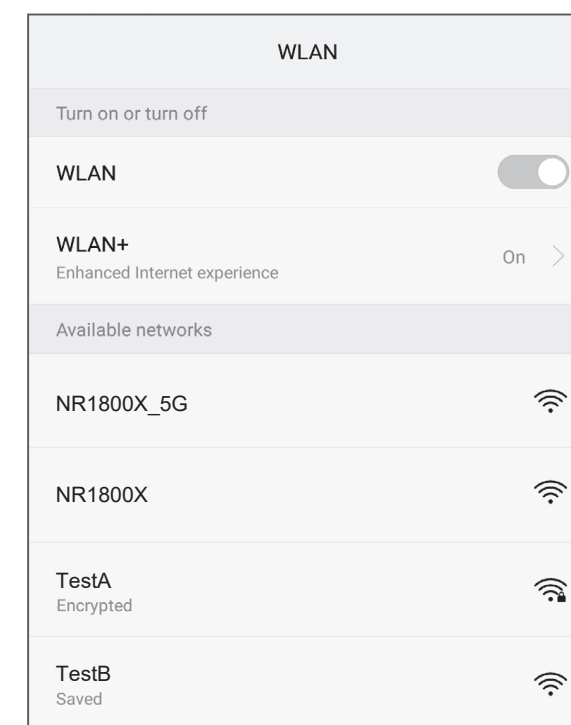

(P1)

2 Enter **admin** for the password and then click **LOGIN**.(P2)

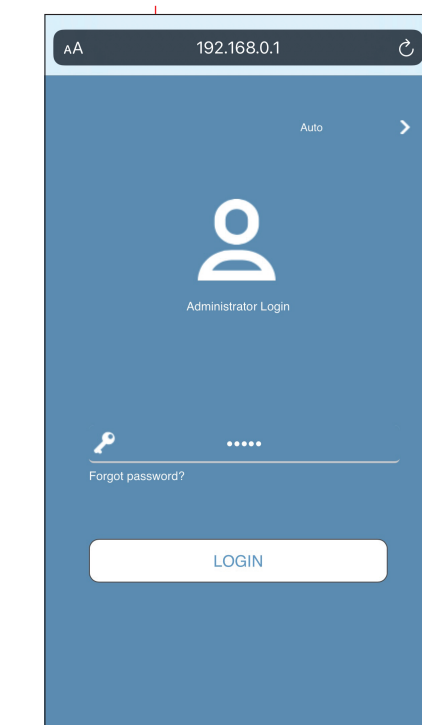

(P2)

3 Click **Quick Setup** on this page, then enter the setting interface. (P3)



(P3)

9 It takes several seconds to save the settings and then your router will restart automatically. This time your Phone will be disconnected from the router. Please back to the WLAN list of your phone to choose the new Wi-Fi name and input the correct password. Now, you could enjoy the Wi-Fi.(P10)

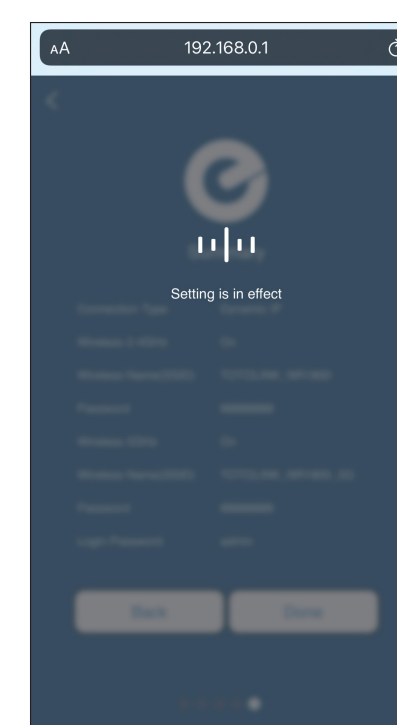

(P10)

3 FAQs (Frequently Asked Questions)

- 1. Unable to open the router's login page on the browser?**
Please check if your Phone has connected to the router and make sure you have entered the correct default gateway <http://itotlink.net>
- 2. How to reset the router to factory default settings?**
Keep the router powered on, then press and hold the WPS/RST button(for more than 5 seconds) until the System indicator becomes quick blinking light.
- 3. How to do if forgetting the router's Login User Name and Password?**
Reset the router to the factory default settings. The User Name and Password would be resumed to **admin**.
- 4. How to do if forgetting the password of the Wi-Fi?**
1)Connect any LAN port of the router and then log in the router on computer to check the Wi-Fi password.
2)Reset the router and configure the router again.
- 5. If connecting the router to the Internet with cable and SIM card simultaneously, how the router works?**
Wireless connection(with SIM card) is a priority to access the Internet when they are available simultaneously. If you want to change the connection mode, please login the router to change.

Connection Type	Description
Static IP	Input the IP address, Subnet Mask, Default Gateway, DNS from your ISP.
Dynamic IP	No information required. Please confirm with your ISP if Dynamic IP is supported.
PPPoE	Input User Name and Password from your ISP.
PPTP	Input Server Address, User Name and Password from your ISP.
L2TP	Input Server Address, User Name and Password from your ISP.

(P6)

FCC Statement

This equipment has been tested and found to comply with the limits for a Class B digital device, pursuant to part 15 of the FCC Rules. These limits are designed to provide reasonable protection against harmful interference in a residential installation. This equipment generates, uses and can radiate radio frequency energy and, if not installed and used in accordance with the instructions, may cause harmful interference to radio communications. However, there is no guarantee that interference will not occur in a particular installation. If this equipment does cause harmful interference to radio or television reception, which can be determined by turning the equipment off and on, the user is encouraged to try to correct the interference by one or more of the following measures:

- Reorient or relocate the receiving antenna.
- Increase the separation between the equipment and receiver.
- Connect the equipment into an outlet on a circuit different from that to which the receiver is connected.
- Consult the dealer or an experienced radio/TV technician for help.

This device complies with part 15 of the FCC Rules. Operation is subject to the following two conditions: (1) This device may not cause harmful interference, and (2) this device must accept any interference received, including interference that may cause undesired operation.

Caution

Any changes or modifications not expressly approved by the party responsible for compliance could void the user's authority to operate the equipment.

Radiation Exposure Statement

This equipment complies with FCC radiation exposure limits set forth for an uncontrolled environment. This transmitter must not be co-located or operating in conjunction with any other antenna or transmitter. This equipment should be installed and operated with minimum distance 20cm between the radiator& your body.

Manufacturer: Shenzhen HDV Photoelectric Technology Co., Ltd.
Address: China shenzhen baoan district fuyong phoenix first industrial zone xu da industrial buildings B 6 floor